

# DC/DC TPS30-150W Print Modul



30 W, 75 W, 150 W

Input Range: 9 - 75  
 Nominal Input: 36 VDC  
 Output Voltage: See Table  
 All Specifications typical at Nominal Line, Full Load, and at 25°C unless otherwise noted  
 $V_{in} = 9 - 12 \text{ V}$ , Output Current =  $0.8 \cdot I_o \text{ max.}$

## Electrical Specifications

### Input

Operating Input Voltage Range: See Table  
 Input Surge Voltage (100 ms max.): 100 VDC (9 - 75 V) max.  
 Under Voltage Lockout: Power up 9 VDC  
 Power Down: 7.5 VDC  
 Positive Logic Remote On/Off: (See Note 5.)  
 Input Filter: LC Type

### Output

Voltage Accuracy:  $\pm 1.5 \%$  max.  
 Transient Response: 25 % Step Load Change:  $< 500 \mu\text{s}$   
 External Trim Adj. Range (Note 6):  $\pm 10 \%$   
 Ripple & Noise, 20 MHz BW:  
 Humidity: 95 % RH max. Non Condensing  
 12 V & 15 V: 60 mV RMS, 120 mV pk-pk max.  
 24 V & 28 V: 100 mV RMS, 280 mV pk-pk max.  
 48 V: 200 mV RMS, 480 mV pk-pk max.  
 Temperature Coefficient:  $\pm 0.03 \%$  / °C  
 Short Circuit Protection: Continuous  
 Line Regulation (Note 1):  $\pm 0.2 \%$  max.  
 Load Regulation (Note 2):  $\pm 0.2 \%$  max.  
 Over Voltage Protection Trip Range, %  $V_o \text{ nom.}$ : 115 - 140 %  
 Current Limit: 105 - 200 % Nominal Output  
 Efficiency: See Table  
 Isolation Voltage: Input/Output 1500 VDC min.  
 Input/Case, Output/Case: 1500 VDC min.  
 Isolation Resistance:  $10^7 \Omega \text{ min.}$   
 Isolation Capacitance: 12 V / 15 V 3500 pF typical  
 24 V, 28 V, 48 V: 2500 pF typical  
 Switching Frequency: 200 KHz typical  
 Operating Case Temperature:  $-40^\circ\text{C} - 100^\circ\text{C}$   
 Storage Temperature:  $-55^\circ\text{C} - 105^\circ\text{C}$   
 Thermal Shutdown, Case Temperature:  $100^\circ\text{C}$  typical  
 MTBF: 300,000/h  
 Dimensions: See Table  
 Case Material: Aluminum Baseplate with Plastic Case  
 Weight: 110 g

## Special Features

- 30 W - 150 W Isolated 1500 VDC
- Efficiency to 91 %
- Fixed Switching Frequency
- Input Under Voltage Protection
- Over Temperature Protection
- Over Voltage/Current Protection
- Remote On/Off
- Industry Standard 1/4, 1/2-Brick Package

## Key Applications

- Industry Automation
- Telecom Communication
- Measuring Equipment
- Military

## Output Derating VS Input Voltage

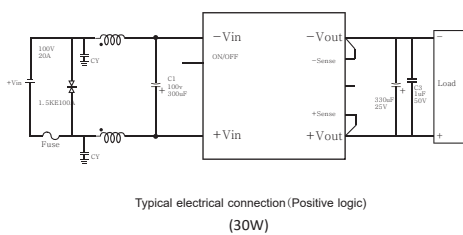
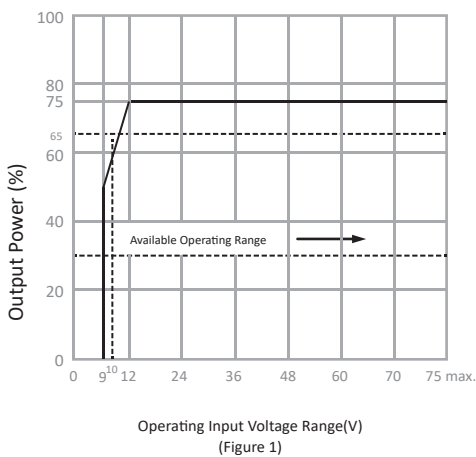

## Safety, EMC

CE compliance with Low-Voltage Directive 2014/35/EU  
 EMC Directive compliance with 2014/30/EU  
 Safety compliance with UL508, UL60950-1, EN60950-1

## NOTE

1. Measured from high Line to low Line  
 Measured from full Load to zero Load
2. Output Ripple/Noise measured with 10 uF Tantalum (for 48 V out with 10 uF Aluminum)  
 and 1 uF Ceramic Capacitor across Output
3. Logic Compatibility open Collector ref. to - Input
4. Start up Time 110 ms typical
5. Module On  $> 3.5 \text{ VDC} - 75 \text{ VDC}$  or Open Circuit  
 Module Off  $< 1.2 \text{ VDC}$
6. The Input external Capacitor recommend to Parallel with 330 uF
7. ESR  $< 0.7 \Omega$  to reduce the Input Ripple Voltage
8. Max. Case Temperature  $100^\circ\text{C}$

# DC/DC TPS30 - 150W Print



## Ordering Information

Article No.	Article Name	Input Voltage (VDC)	Output Voltage (VDC)	Output Current (A)	% Eff.	Capacitive load max	Dimension L*W*H (mm)
901003010-42417	TPS30-PMD12S	9 - 75	12	0 - 2.5	85 %	1000 UF	37.2*57.9*12.7
901003009-42416	TPS30-PMD24S	9 - 75	24	0 - 1.2	85 %	500 UF	37.2*57.9*12.7
901003005-42424	TPS75-PMD12S	9 - 75	12	0 - 6.2	89 %	2000 UF	37.2*57.9*12.7
901003006-42425	TPS75-PMD24S	9 - 75	24	0 - 3.1	89 %	1000 UF	37.2*57.9*12.7
901003003-42426	TPS150-PMD12S	9 - 75	12	0 - 12.5	88 %	5000 UF	61*57.9*12.7
901003004-42427	TPS150-PMD24S	9 - 75	24	0 - 6.2	89 %	2000 UF	61*57.9*12.7
901003007-42428	TPS150-PMD12D	9 - 75	12/12	0 - 6.2/0 - 6.2	88 %	2000 UF	61*57.9*12.7
901003008-42429	TPS150-PMD24D	9 - 75	24/24	0 - 3.1/0 - 3.1	89 %	1000 UF	61*57.9*12.7

## Accessories and Packing

- 1 x Power Supply
- 1 x Manual

## Pin Assignment and Dimension (mm)

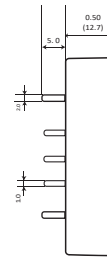
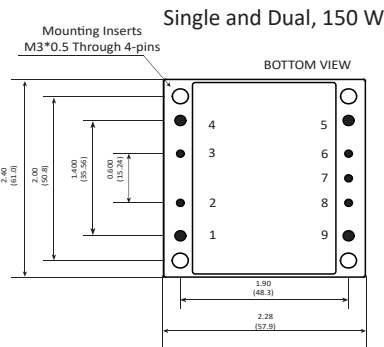
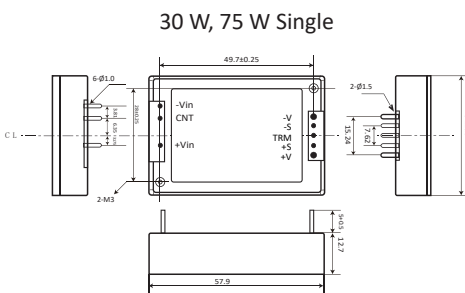

### Single, 150 W

Pin	Function
1	+V Input
2	ON/OFF
3	CASE
4	-V Input
5	-V Output
6	-Sense
7	Trim
8	+Sense
9	+V Output

### Dual, 150 W

Pin	Function
1	+V Input
2	ON/OFF
3	CASE
4	-V Input
5	-V Output
6	-Sense
7	NC
8	+Sense
9	+V Output

Heat Sink for 30 W / 75 W (optional) Article: 507020102

Heat Sink for 150 W (optional) Article: 507020101

Material: Alu-6061

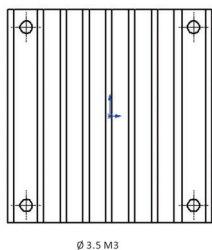
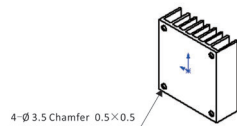
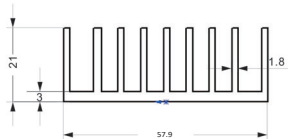

### REMOTE ON/OFF CONTROL

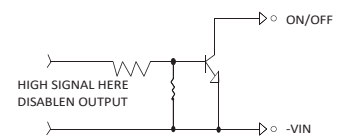

### EXTERNAL OUTPUT TRIM

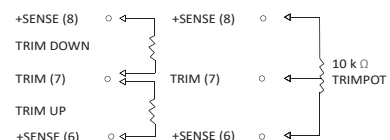

Dieses elektronische Gerat darf am Ende seiner Lebensdauer nicht im Hausmull entsorgt werden. Zur Ruckgabe stehen in Ihrer Nahе kostenfreie Sammelstellen fur Elektroaltgerate sowie ggf. weitere Annahmestellen fur die Wiederverwendung der Gerate zur Verfugung. Entsprechende Adressen erhalten Sie von Ihrer Stadt- bzw. Kommunalverwaltung. Sollte das alte Elektro- bzw. Elektronikgerat personenbezogene Daten enthalten, sind Sie selbst fur die Loschung dieser Ihrer Daten verantwortlich, bevor sie es zuruck geben. Weitere nutzliche Informationen finden sie auf: [www.elektrogesetz.de](http://www.elektrogesetz.de)

This electronic device must not be disposed of in the household waste at the end of its service life. For your return, there are free collection points for electrical appliances and, if necessary, additional points of acceptance for the reuse of the devices in your area. The addresses can be obtained from your city or communal administration. If the old electrical or electronic device contains personal data, you are responsible for deleting it before you return it. Further information: [www.elektrogesetz.de](http://www.elektrogesetz.de)